

BEFORE REMOVING ANY WELDS

CUT THE PIN ENGAGEMENT SPRING AND PIN RETRACTION SPRING TO RELEASE THE COMPRESSION.

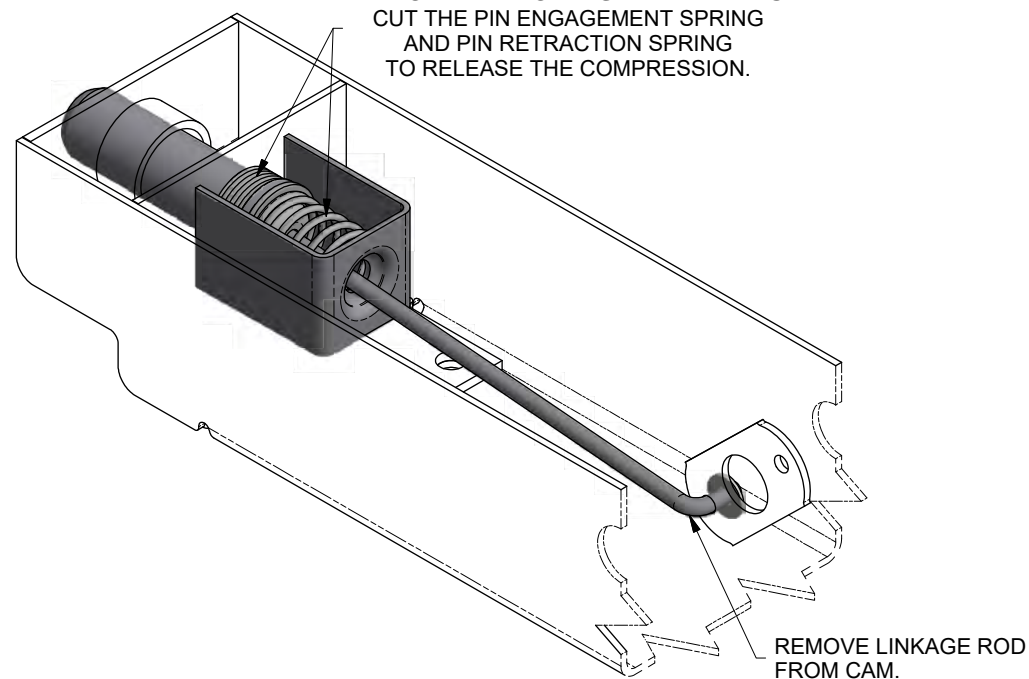

STEP 1

REMOVE WELDS AND CLEAN SUPPORT PLATE SURFACE.

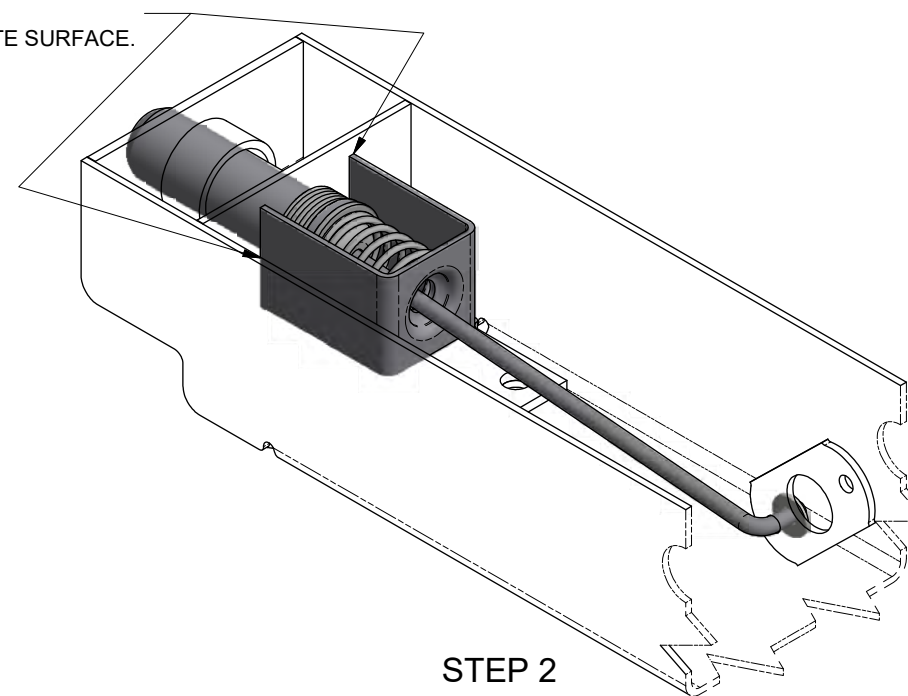

STEP 2

POSITION THE SPRING CAGE. THE LOCK PIN HOLE MUST BE INLINE WITH THE SUPPORT PLATE HOLE.

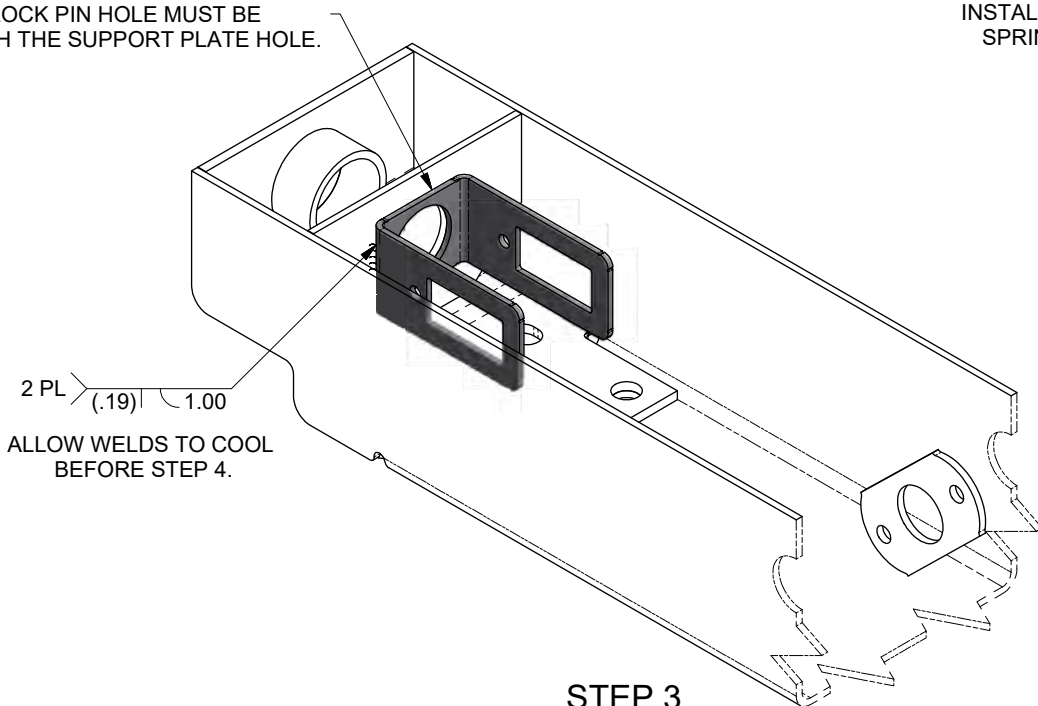

STEP 3

INSTALL THE PIN RETRACTION SPRING AND THE LOCK PIN

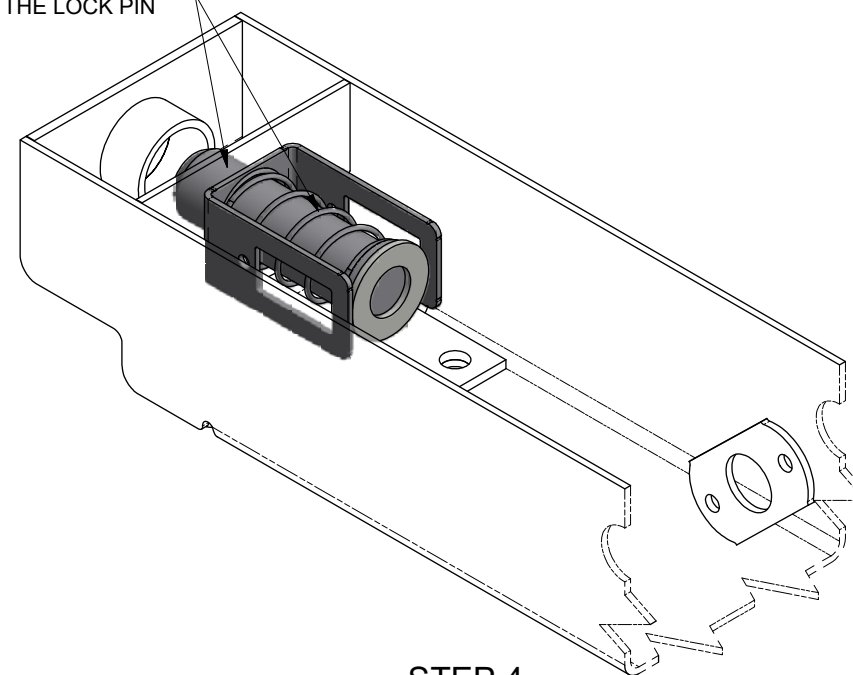

STEP 4

HOLD THE LOCK PIN IN THE OUTBOARD POSITION (CLAMP, VISE GRIP, ETC.)

COMPRESS THE LOCK PIN AND RETRACTION SPRING

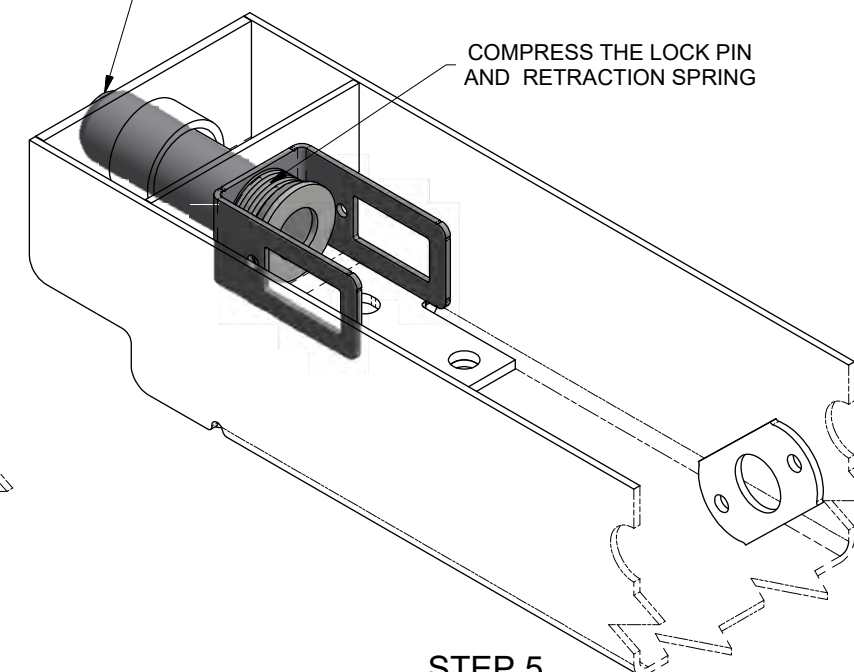

STEP 5

3. MAKE SURE LOCK PINS EXTEND AND FULLY RETRACT BEFORE PLACING SLIDER IN SERVICE.

2. SLIDER MODEL: H9036I.

1. INSTALLATION PROCEDURE FOR KIT 29558-03.

NEXT ASSY: NEXT		ER NO.	SYM	DATE	BY	CHK	APPD
TOLERANCES (UNLESS OTHERWISE SPECIFIED)		DRAWN:	ML	3/22/2018			
DECIMAL .X ± .1		CHECKED:	JAJ	10/4/2018			
DECIMAL .XX ± .06		APPROVED:	RSB	10/4/2018			
DECIMAL .XXX ± .030		MFG APPL:	N/A	DATE: XXX/XX/XX			
ANGULAR ± 1°		ER:	2018044	DATE: 10/5/2018			
HOLES:		PROJECT OR FILE REFERENCE NO.	PROJ#: 20180400				
.50 DIA AND LESS: ± .007		EPR#:	EPR#: 20180400-01				
.51 DIA AND GREATER: ± .01		SCALE:	D SIZE - 1/2				
REMOVE ALL SHARP BURRS & SHARP CORNERS THAT MIGHT AFFECT ASSEMBLY, APPEARANCE, OR OPERATION OF OUR PRODUCTS.		B SIZE - 1/4	SHEET 1 OF 2		SIZE:	D	DRAWING NO.: 29624
		REV. 1 OF 2					

This confidential drawing is the property of Hutchens Industries, Inc. Hutchens Industries makes no warranties regarding the information on this document. Nothing herein may be transmitted or disclosed in whole or in part to other parties. The recipient of this drawing agrees not to use the information for manufacturing, nor will they modify, distribute, reverse engineer, or create derivative works based on the information contained on this print without the prior written permission of Hutchens Industries, Inc. The recipient agrees not to make copies of the document or reproduce in any manner the information in the document and to return it to Hutchens Industries upon request. Any use of this document is acceptance of the terms stated above.

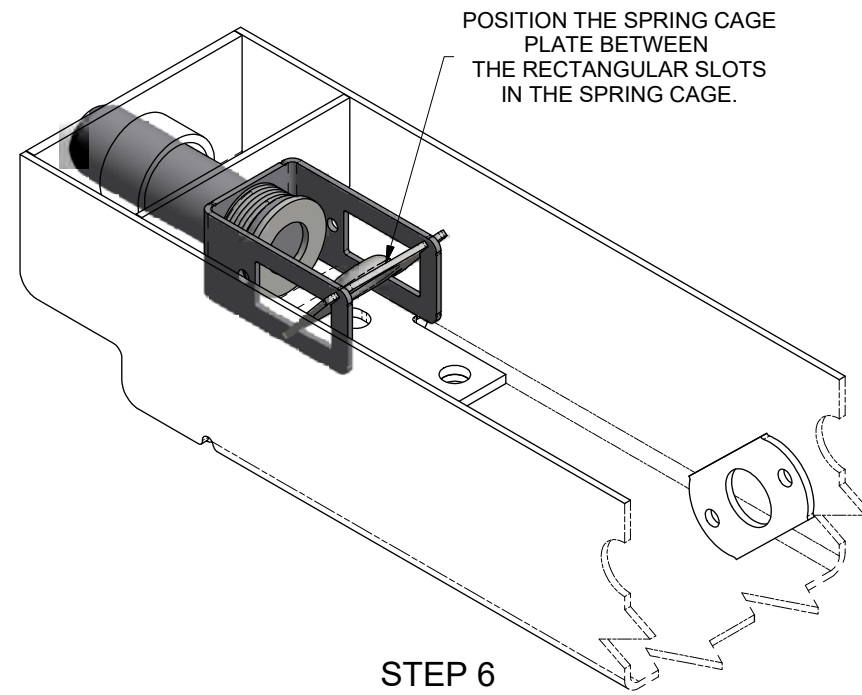

STEP 6

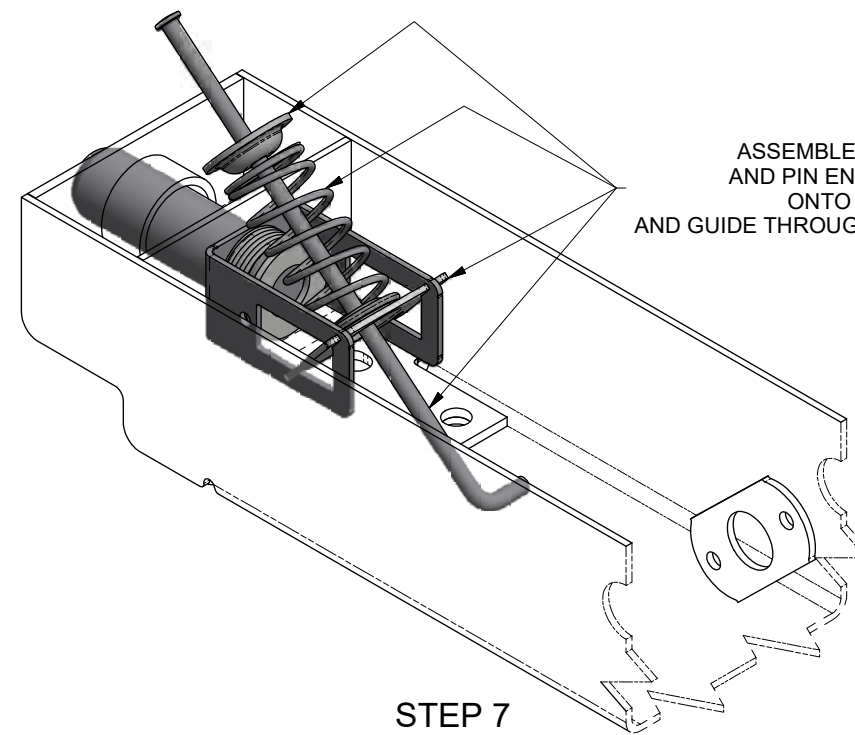

STEP 7

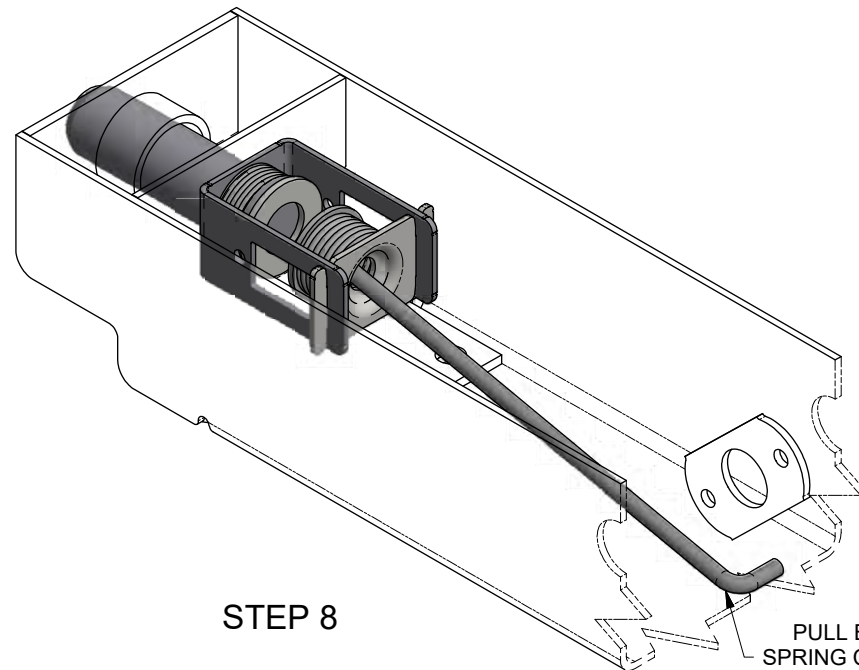

STEP 8

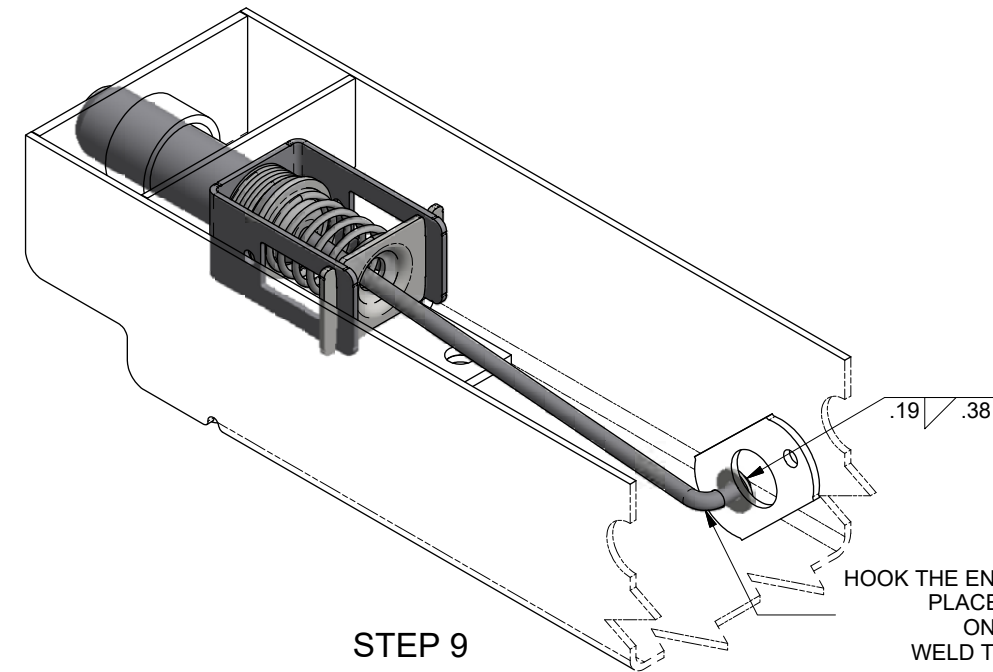

STEP 9

3. MAKE SURE LOCK PINS EXTEND AND FULLY RETRACT BEFORE PLACING SLIDER IN SERVICE.
2. SLIDER MODEL: H9036I.
1. INSTALLATION PROCEDURE FOR KIT 29558-03.

NEXT ASSY: NEXT		ER NO.	SYM	DATE	BY	CHK	APPD
TOLERANCES (UNLESS OTHERWISE SPECIFIED)		DRAWN:	ML	3/22/2018			
DECIMAL .X ± .1		CHECKED:	JAJ	10/4/2018			
DECIMAL .XX ± .06		APPROVED:	RSB	10/4/2018			
DECIMAL .XXX ± .030		MFG APPL:	N/A	XXXXXX			
ANGULAR ± 1°		ER:	2018044	10/5/2018			
HOLES:		PROJECT OR FILE REFERENCE NO.:	PROJ#: 20180400				
.50 DIA AND LESS: ± .007		EPR#:	20180400-01				
.51 DIA AND GREATER: ± .01		SCALE:	D SIZE - 1/2		SHEET 2 OF 2		REV. 2 OF 2
REMOVE ALL SHARP BURRS & SHARP CORNERS THAT MIGHT AFFECT ASSEMBLY, APPEARANCE, OR OPERATION OF OUR PRODUCTS.		B SIZE - 1/4		DRAWING NO.:		29624	



INSTALLATION PROCEDURE FOR 29558-03 KIT

This confidential drawing is the property of Hutchens Industries. Hutchens Industries makes no warranties regarding the information on this document. Nothing herein may be transmitted or disclosed in whole or in part to other parties. The recipient of this drawing agrees not to use the information for manufacturing, nor will they modify, distribute, reverse engineer, or create derivative works based on the information contained on this print without the prior written permission of Hutchens Industries. The recipient agrees not to make copies of the document or reproduce in any manner the information in the document and to return it to Hutchens Industries upon request. Any use of this document is acceptance of the terms stated above.