

**BEFORE REMOVING ANY WELDS**  
CUT THE PIN ENGAGEMENT SPRING  
AND PIN RETRACTION SPRING  
TO RELEASE THE COMPRESSION.

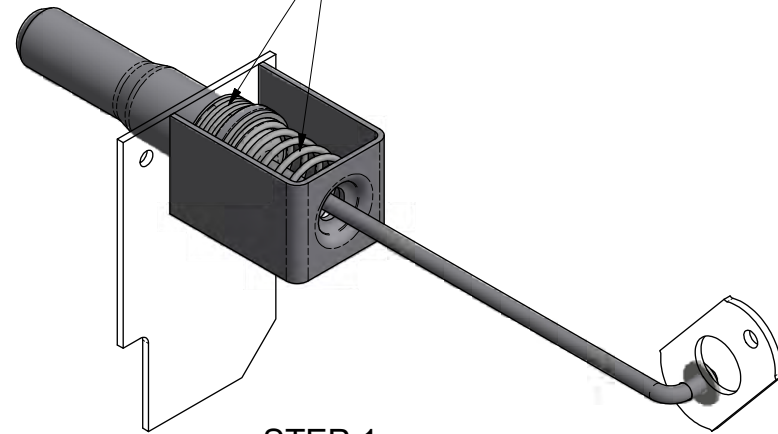

STEP 1

REMOVE WELDS  
AND  
CLEAN SUPPORT PLATE SURFACE

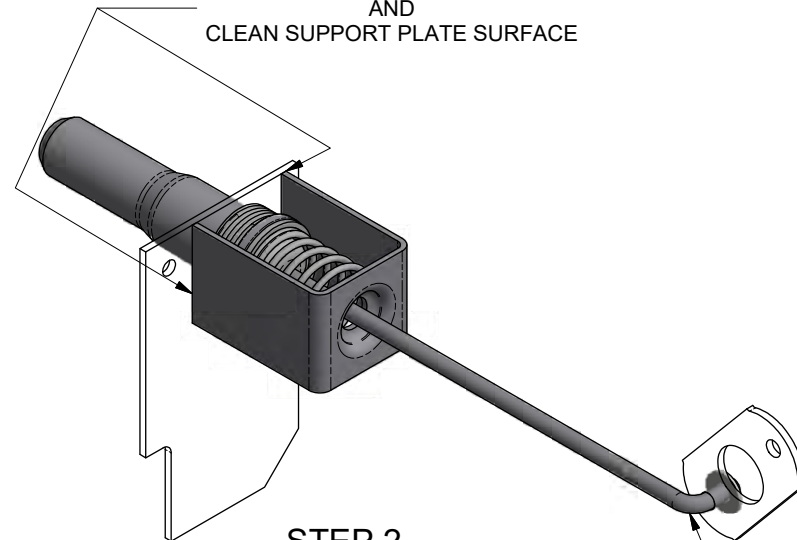

STEP 2

REMOVE LINKAGE ROD  
FROM CAM

POSITION THE SPRING CAGE.  
THE LOCK PIN HOLE MUST BE  
INLINE WITH THE SUPPORT PLATE HOLE.

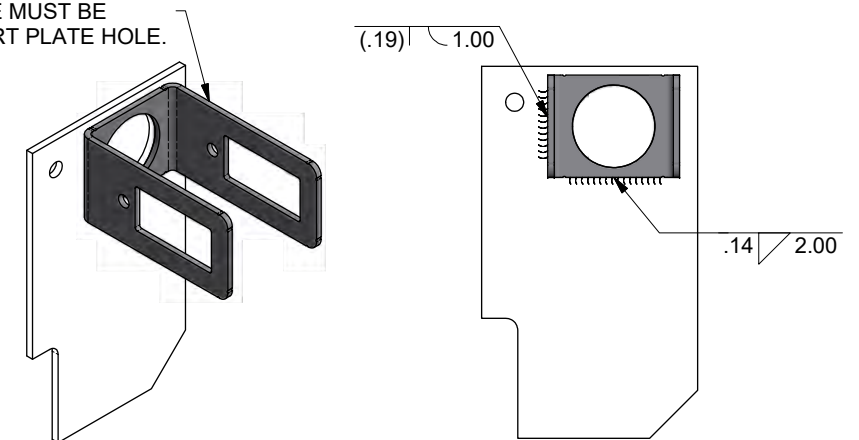

ALLOW WELDS TO COOL  
BEFORE STEP 4.

STEP 3

INSTALL THE PIN RETRACTION  
SPRING AND THE LOCK PIN

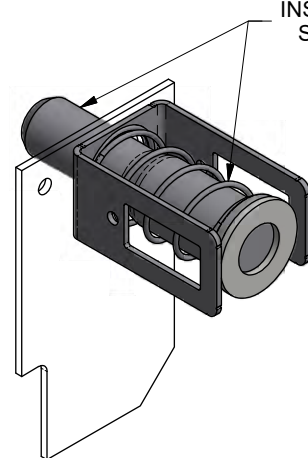

STEP 4

COMPRESS THE LOCK PIN AND RETRACTION SPRING.  
INSERT A RETAINER ( ROD, SCREWDRIVER, ETC.)  
THROUGH THE PIN CAGE HOLES.

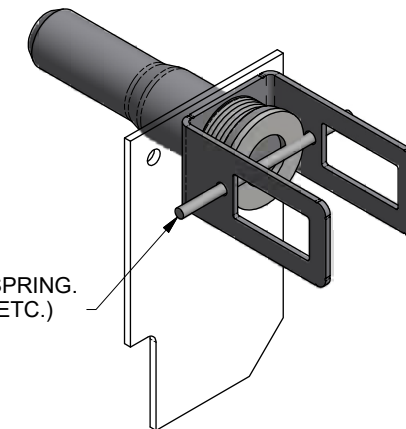

STEP 5

3. MAKE SURE LOCK PINS EXTEND AND FULLY  
RETRACT BEFORE PLACING SLIDER IN SERVICE.

2. SLIDER MODEL: DANA AIR RIDE.

1. INSTALLATION PROCEDURE FOR KIT 29573-03 AND -04.

NEXT ASSY: NEXT		ER NO.	SYM	DATE	BY	CHK	APPD
TOLERANCES (UNLESS OTHERWISE SPECIFIED) DECIMAL .X ± .1 DECIMAL .XX ± .06 DECIMAL .XXX ± .030 ANGULAR ± 1°		DRAWN:	ML	3/22/2018			
HOLES: .50 DIA AND LESS: ± .007 .51 DIA AND GREATER: ± .01 REMOVE ALL SHARP BURRS & SHARP CORNERS THAT MIGHT AFFECT ASSEMBLY, APPEARANCE, OR OPERATION OF OUR PRODUCTS.		CHECKED:	JAJ	10/4/2018			
		APPROVED:	RSB	10/4/2018			
		MFG APPL:	N/A	DATE: XX/XX/XX			
		ER:	2018044	DATE: 10/5/2018			
		PROJECT OR FILE REFERENCE NO.:	PROJ#: 20180400				
			EPR#: 20180400-01				
		SCALE:	D SIZE - 1/2				
			B SIZE - 1/4				
		SHEET 1 OF 2		SIZE:	D	DRAWING NO.:	29681
				REV.	-	1 OF 2	

This confidential drawing is the property of Hutchens Industries, Hutchens Industries makes no warranties regarding the information on this document. Nothing herein may be transmitted or disclosed in whole or in part to other parties. The recipient of this drawing agrees not to use the information for manufacturing, nor will they modify, distribute, reverse engineer, or create derivative works based on the information contained on this print without the prior written permission of Hutchens Industries. The recipient agrees not to make copies of the document or reproduce in any manner the information in the document and to return it to Hutchens Industries upon request. Any use of this document is acceptance of the terms stated above.

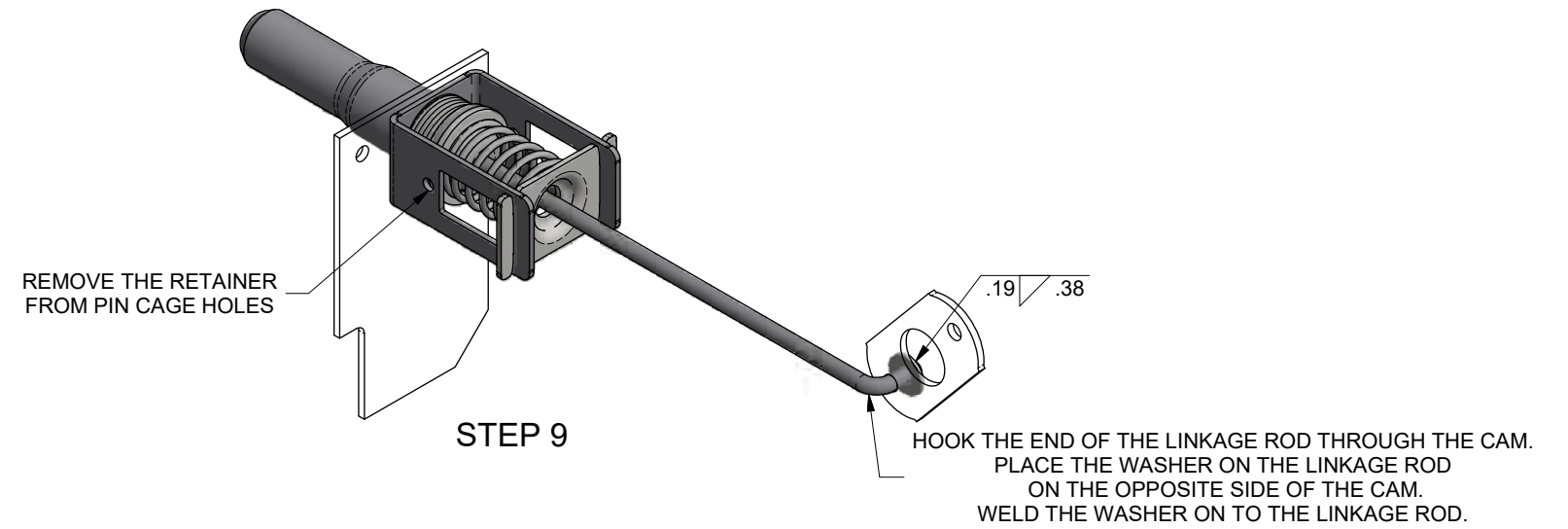
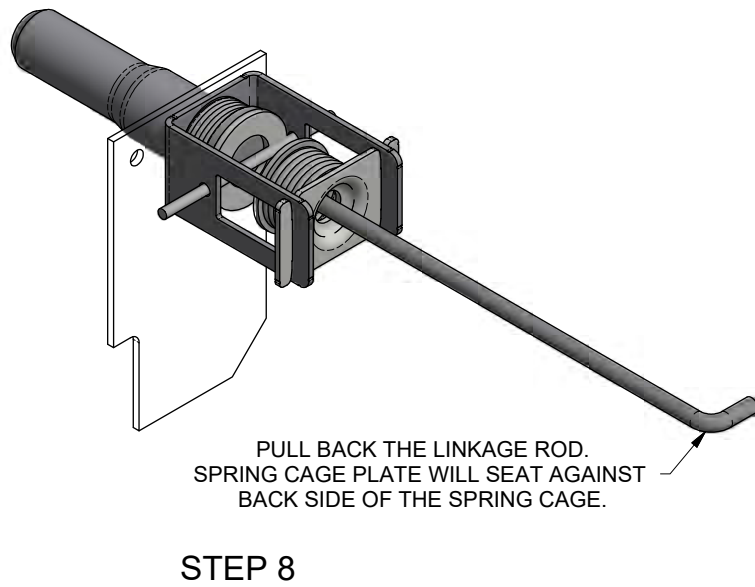
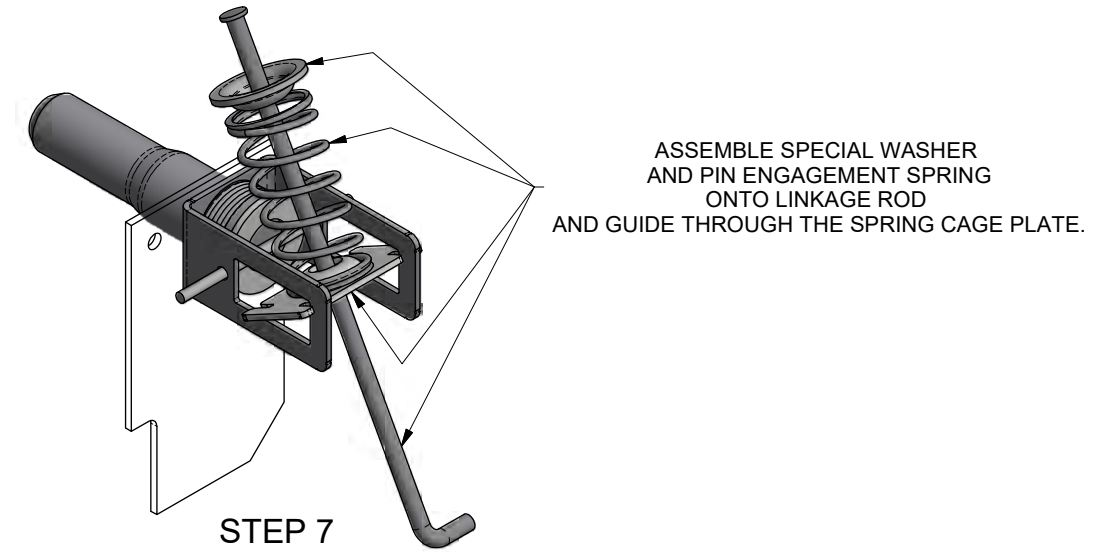
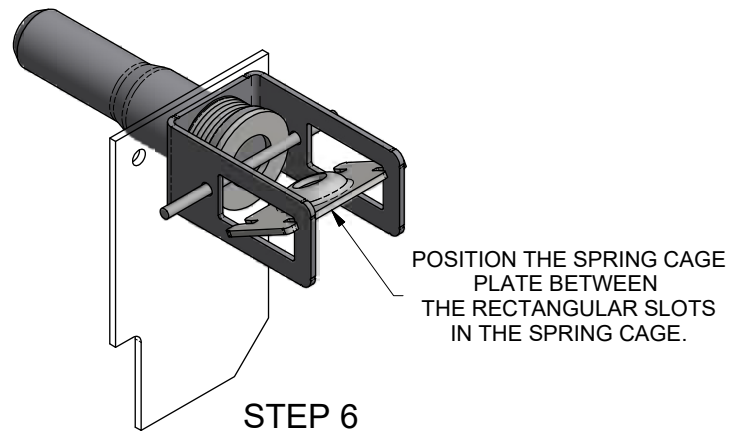

3. MAKE SURE LOCK PINS EXTEND AND FULLY RETRACT BEFORE PLACING SLIDER IN SERVICE.
2. SLIDER MODEL: DANA AIR RIDE.
1. INSTALLATION PROCEDURE FOR KIT 29573-03 AND -04.

NEXT ASSY: NEXT		ER NO.	SYM	DATE	BY	CHK	APPD
TOLERANCES (UNLESS OTHERWISE SPECIFIED)		DRAWN:	ML	3/22/2018			
DECIMAL .X ± .1		CHECKED:	JAJ	10/4/2018			
DECIMAL .XX ± .06		APPROVED:	RSB	10/4/2018			
DECIMAL .XXX ± .030		MFG APPL:	N/A	DATE: XXX/XX/XX			
ANGULAR ± 1°		ER:	2018044	DATE: 10/5/2018			
HOLES:		PROJECT OR FILE REFERENCE NO.					
.50 DIA AND LESS: ± .007		PROJ#: 20180400					
.51 DIA AND GREATER: ± .01		EPR#: 20180400-01					
REMOVE ALL SHARP BURRS & SHARP CORNERS THAT MIGHT AFFECT ASSEMBLY, APPEARANCE, OR OPERATION OF OUR PRODUCTS.		SCALE:		D SIZE - 1/2		SHEET 2 OF 2	
				B SIZE - 1/4		DRAWING NO.: 29681	

This confidential drawing is the property of Hutchens Industries, Hutchens Industries makes no warranties regarding the information on this document. Nothing herein may be transmitted or disclosed in whole or in part to other parties. The recipient of this drawing agrees not to use the information for manufacturing, nor will they modify, distribute, reverse engineer, or create derivative works based on the information contained on this print without the prior written permission of Hutchens Industries. The recipient agrees not to make copies of the document or reproduce in any manner the information in the document and to return it to Hutchens Industries upon request. Any use of this document is acceptance of the terms stated above.

DRAWING NO. 29681 REV. 2 OF 2