

HUTCHENS INDUSTRIES INC.

LOGO LOCATION

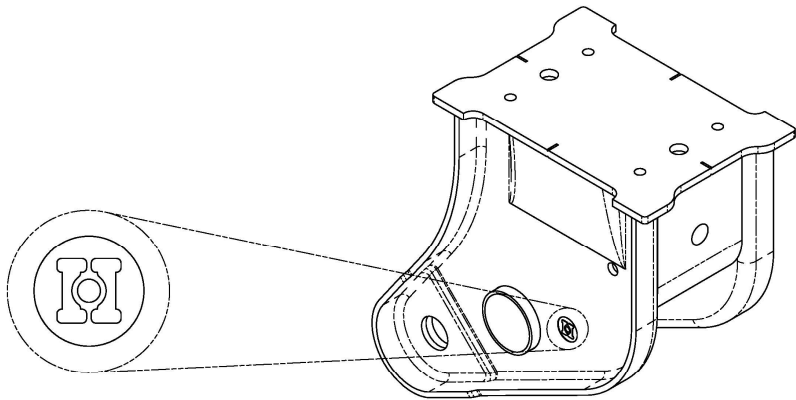

LOGO LOCATION TYPICAL FOR FABRICATED FRONT HANGERS

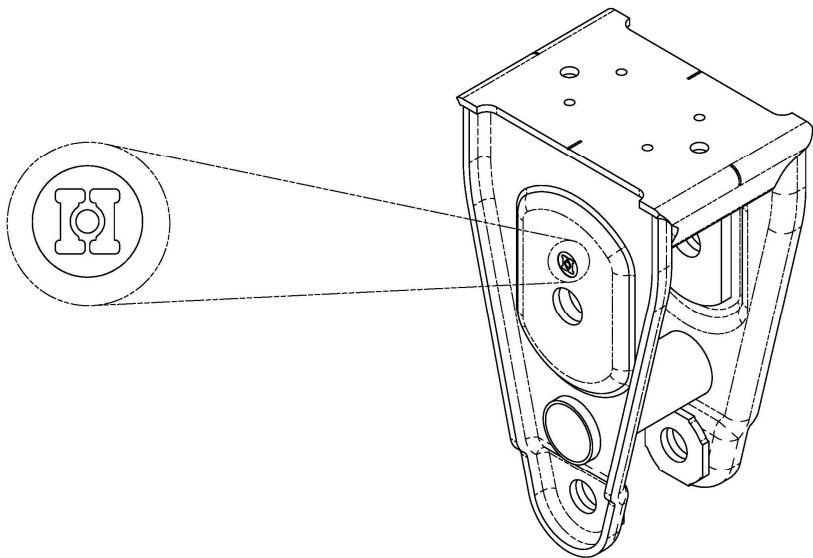

LOGO LOCATION TYPICAL FOR FABRICATED CENTER HANGERS

NOTE: THE HUTCH LOGO IS A REGISTERED TRADEMARK OF HUTCHENS INDUSTRIES INC.

HUTCH LOGO LOCATION H9600/H9700 COMPONENTS	ER: 2011065	REV:	SHEET 1 OF 5
		DATE:	
	PROJ: 2010500	REV ER:	DRAWING NO. 25958

HUTCHENS INDUSTRIES INC.

LOGO LOCATION

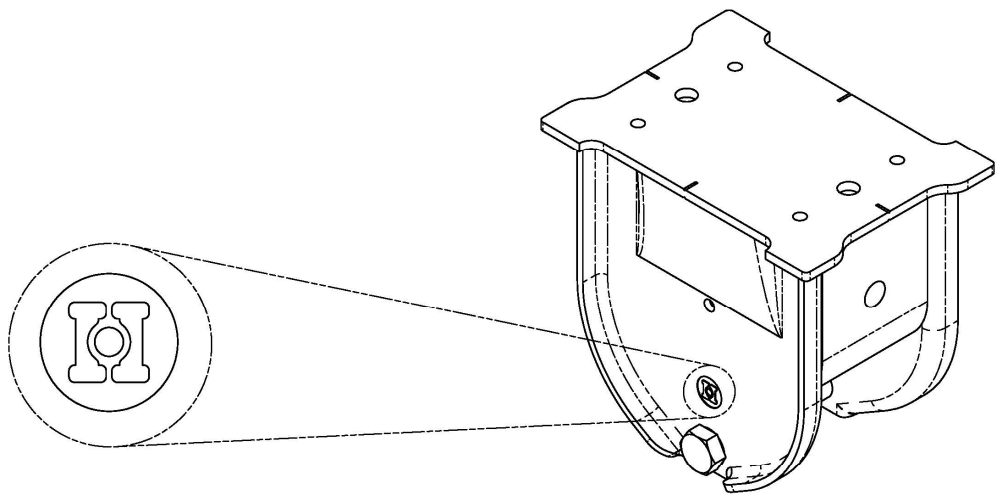

LOGO LOCATION TYPICAL FOR FABRICATED REAR HANGERS

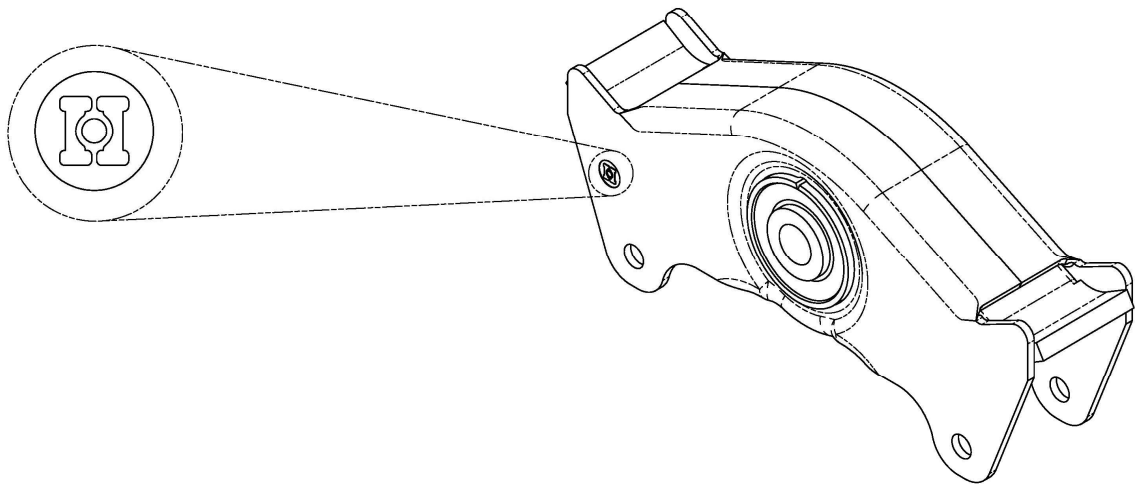

LOGO LOCATION TYPICAL FOR FABRICATED ROCKERS

NOTE: THE HUTCH LOGO IS A REGISTERED TRADEMARK OF HUTCHENS INDUSTRIES INC.

HUTCH LOGO LOCATION H9600/H9700 COMPONENTS	ER:	REV:	SHEET
	2011065	DATE:	
	PROJ:	REV ER:	DRAWING NO.
	2010500		25958

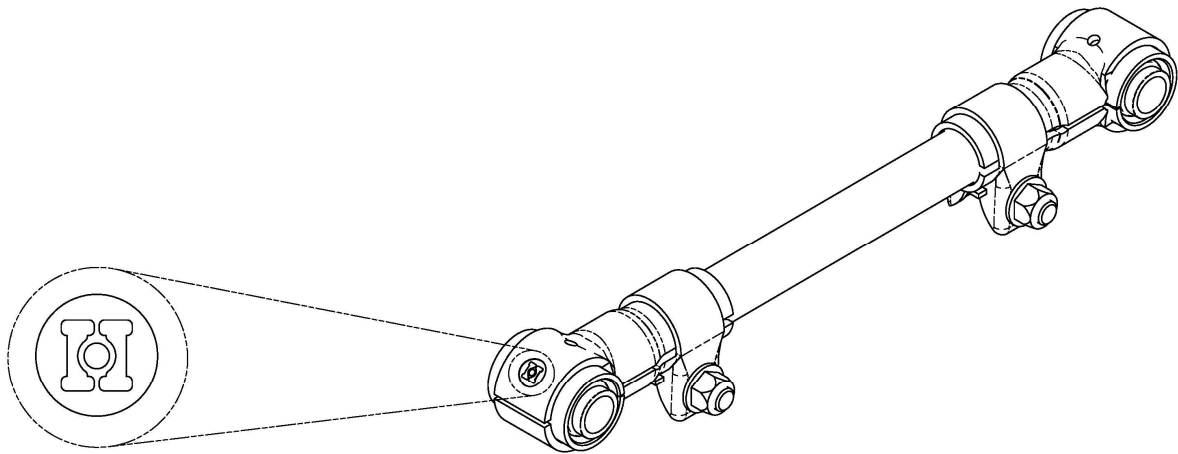

LOGO LOCATION TYPICAL FOR ADJUSTABLE RADIUS ROD

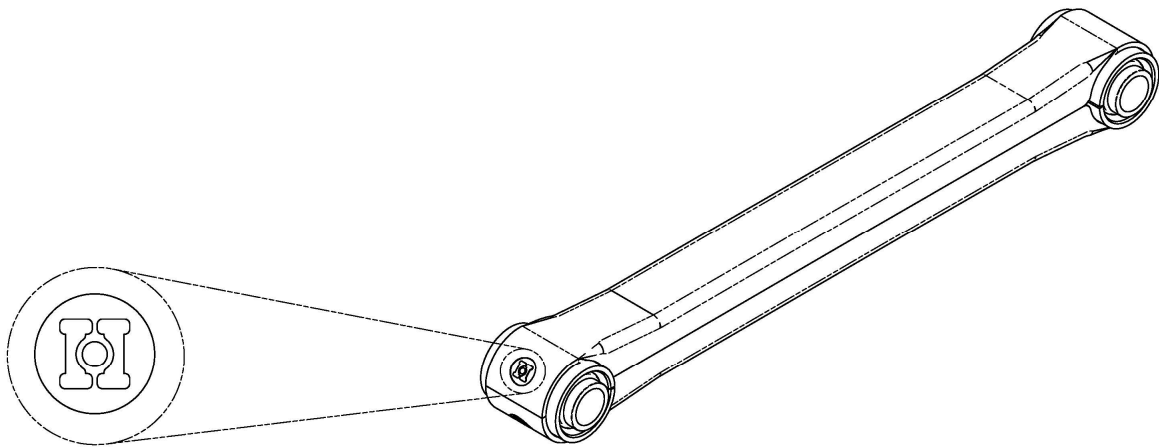

LOGO LOCATION TYPICAL FOR FIXED RADIUS ROD

NOTE: THE HUTCH LOGO IS A REGISTERED TRADEMARK OF HUTCHENS INDUSTRIES INC.

HUTCH LOGO LOCATION H9600/H9700 COMPONENTS	ER:	REV:	SHEET
	2011065	DATE:	
	PROJ:	REV ER:	DRAWING NO.
	2010500		25958

HUTCHENS INDUSTRIES INC.

LOGO LOCATION

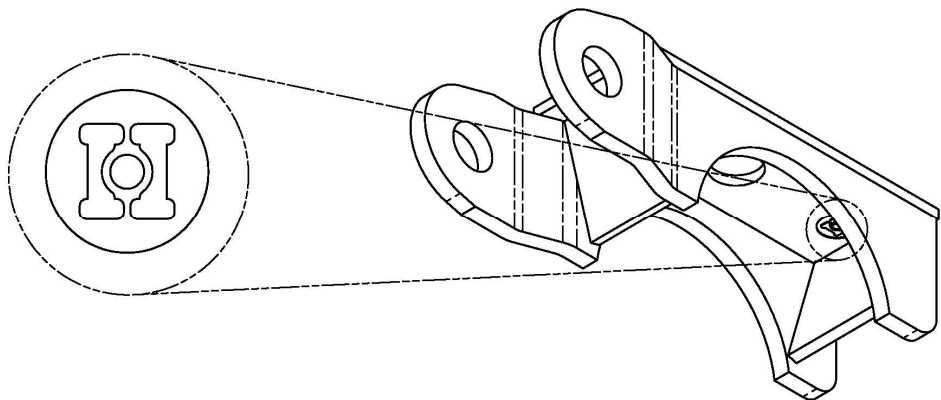
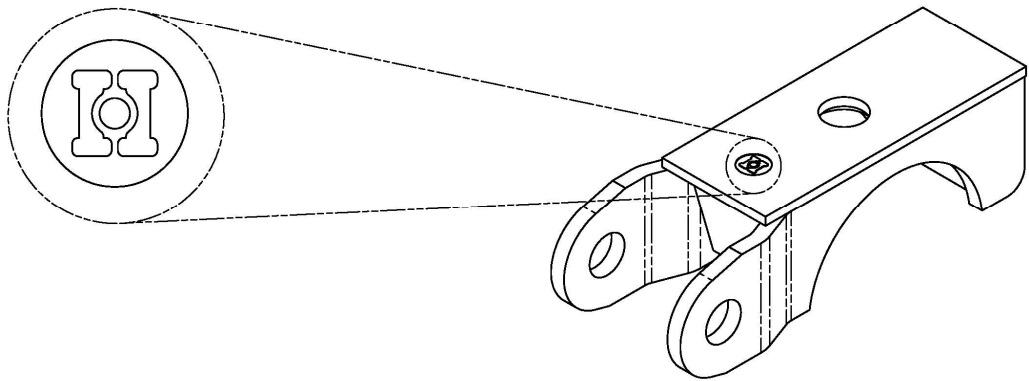

LOGO LOCATION TYPICAL FOR SPRING SEAT

NOTE: THE HUTCH LOGO IS A REGISTERED TRADEMARK OF HUTCHENS INDUSTRIES INC.

HUTCH LOGO LOCATION H9600/H9700 COMPONENTS	ER: 2011065	REV:	SHEET 4 OF 5
		DATE:	
	PROJ: 2010500	REV ER:	DRAWING NO. 25958

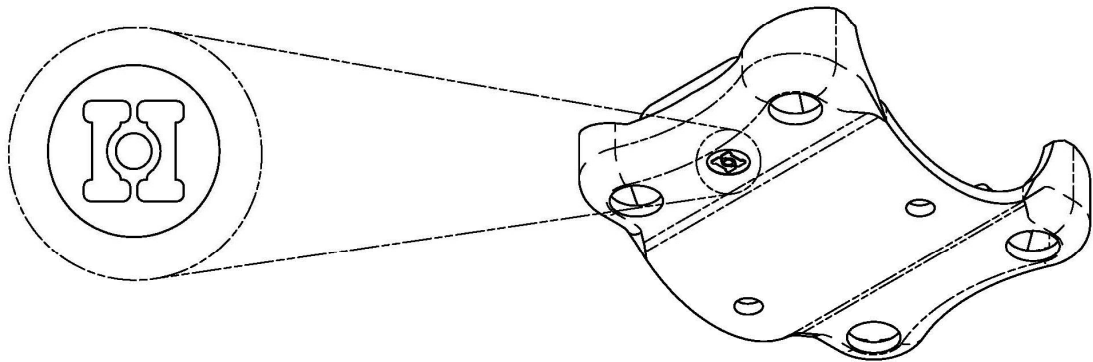

LOGO LOCATION TYPICAL FOR THE BOTTOM PLATE

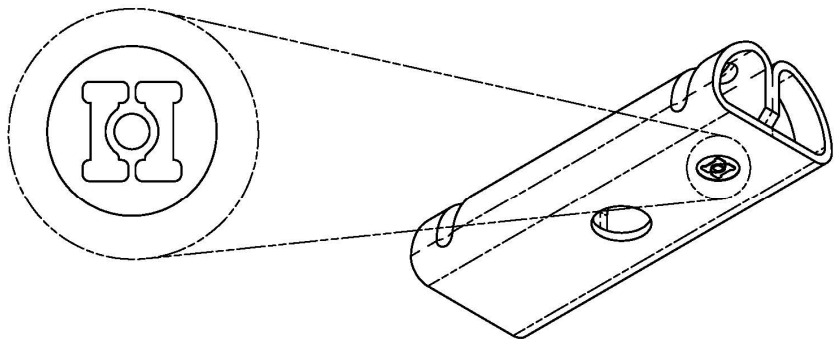

LOGO LOCATION TYPICAL FOR THE TOP PLATE

NOTE: THE HUTCH LOGO IS A REGISTERED TRADEMARK OF HUTCHENS INDUSTRIES INC.

HUTCH LOGO LOCATION H9600/H9700 COMPONENTS	ER:	REV:	SHEET
	2011065	DATE:	
	PROJ:	REV ER:	DRAWING NO.
	2010500		25958